

# A2 模造紙單色印刷70g

akasa.

## Venom voodoo

USER Manual GB FR D PT ES

**GB**  
**WARNING**  
Improper installation will result in damage to the processor. Never switch on the computer system until the fan is connected to the motherboard power connector.  
**Caution**  
Electrostatic discharge (ESD) can damage system components. Use an ESD-controlled workstation. If such a workstation is not available, wear an antistatic wrist strap or touch an earthed surface before handling any PC components.

**FR**  
**AVERTISSEMENT**  
Une installation incorrecte endommagera le processeur. N'allez jamais l'ordinateur avant que le ventilateur ne soit connecté au connecteur d'alimentation de la carte mère.  
**Attention**  
Une décharge électrostatique (ESD) peut endommager les composants du système. Utilisez une station de travail protégée contre l'ESD. Si vous ne disposez pas d'une telle station de travail, portez une bracelet antistatique ou touchez une surface connectée à la masse avant de manipuler les composants du PC.

**D**  
**WARNUNG**  
Falsche bei der Installation können zu Schäden am Prozessor führen. Schalten Sie das Computersystem erst wieder ein, wenn der Lüfter an das Motherboard angeschlossen wurde.  
**Vorsicht**  
Statische Entladungen können durch elektrostatische Entladung beschädigt werden. Benutzen Sie einen für ESD schützenden Arbeitsplatz. Sollte ein solcher Arbeitsplatz nicht verfügbar sein, tragen Sie ein antistatische Armband oder berühren Sie eine geerdete Oberfläche vor dem Handeln mit PC-Komponenten.

**PT**  
**ATENÇÃO**  
Uma instalação incorreta pode danificar o processador. Nunca ligue o computador, sem verificar se o cooler está ligado ao conector de força da placa-mãe.  
**Cuidado**  
Descargas Eletrostáticas (ESD) podem danificar componentes do PC. Use uma bancada com controle de ESD. Caso não tenha uma bancada específica disponível, utilize uma pulseira anti-estática ou toque uma superfície aterrada antes de manipular qualquer componente do PC.

**ES**  
**ADVERTENCIA**  
Una instalación incorrecta puede provocar daños al procesador. Nunca encienda el ordenador antes de que el ventilador esté conectado al conector de corriente de la placa madre.  
**CUIDADO**  
Descargas electrostáticas (ESD) pueden dañar componentes en el sistema. Use una estación de trabajo con control de ESD. Si no tiene disponible dicho lugar de trabajo, colóquese una pulsera antiestática o toque una superficie conectada a tierra antes de tocar cualquier componente en el PC.

### Contents

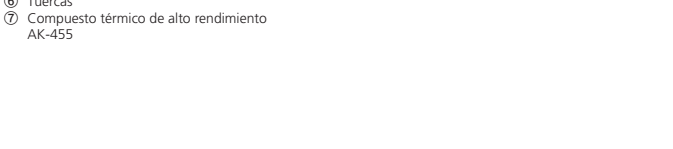
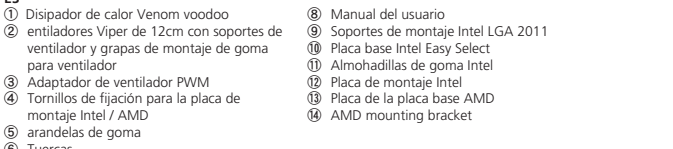
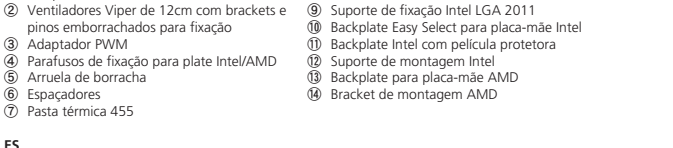
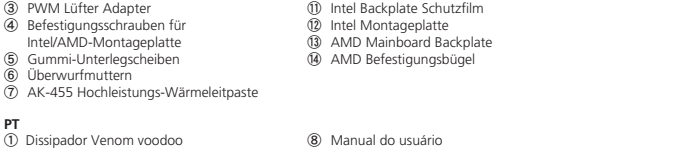
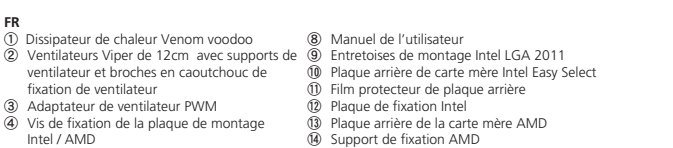
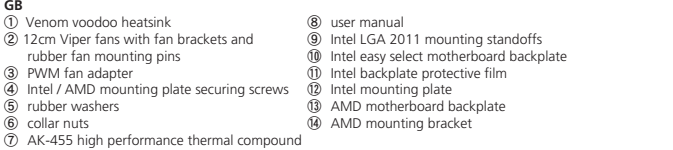
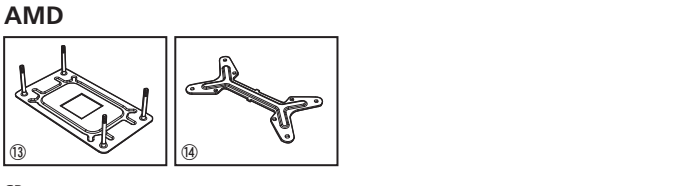
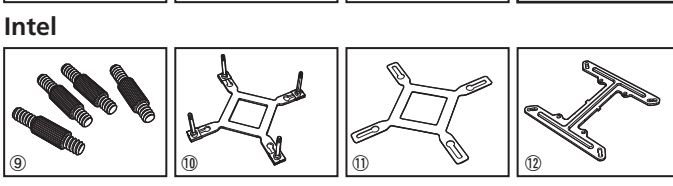
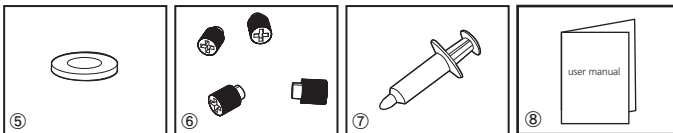
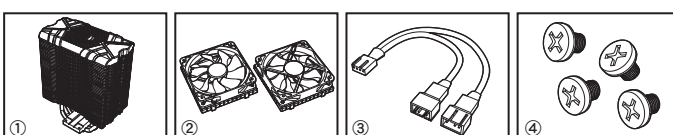

### Intel LGA2011

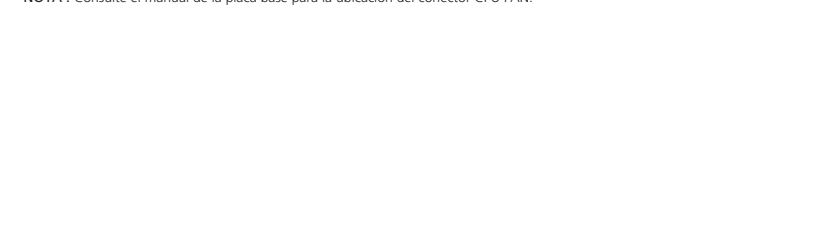
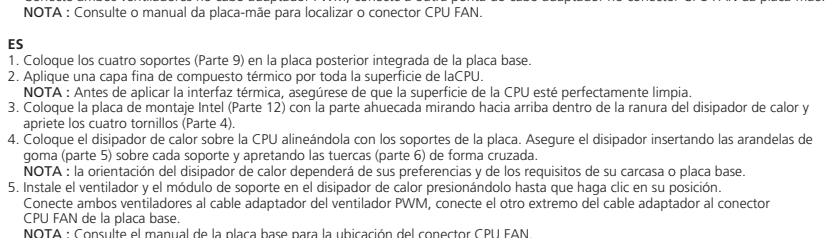
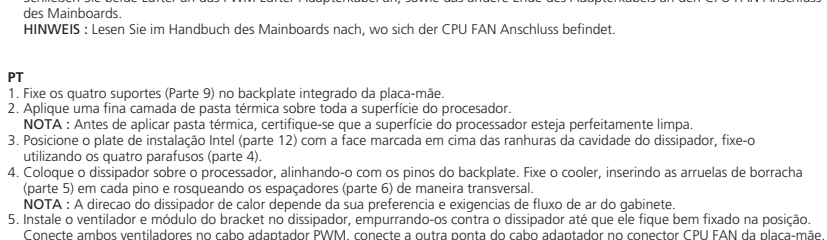
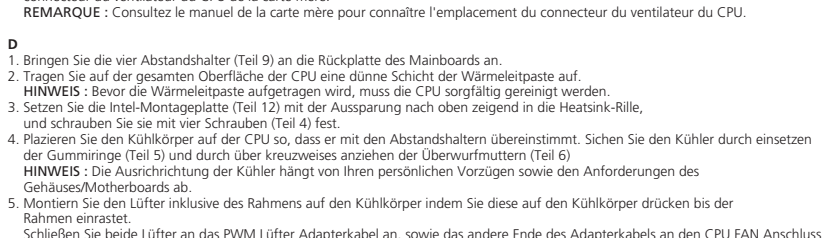
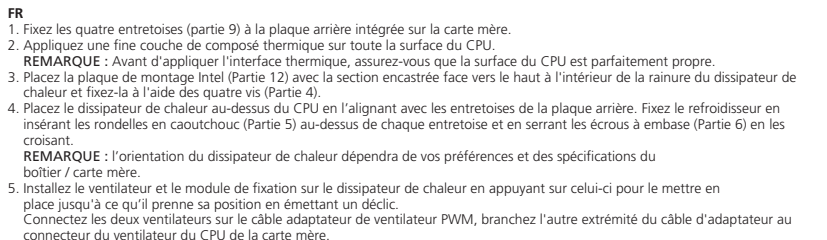
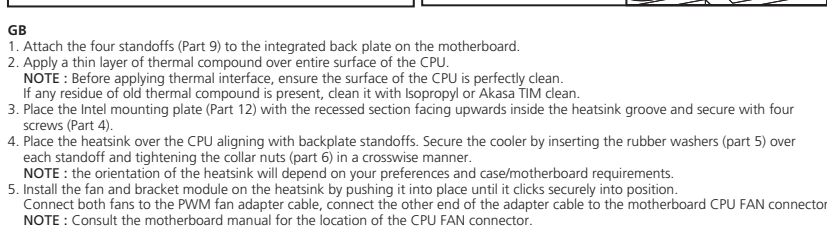
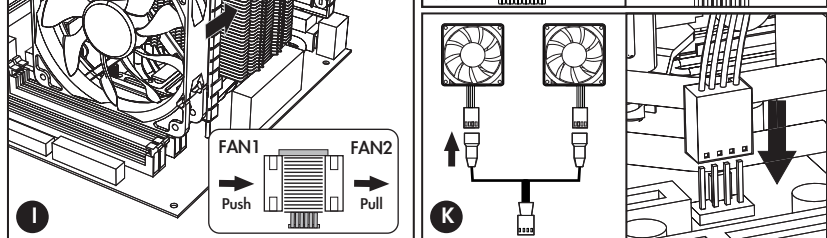
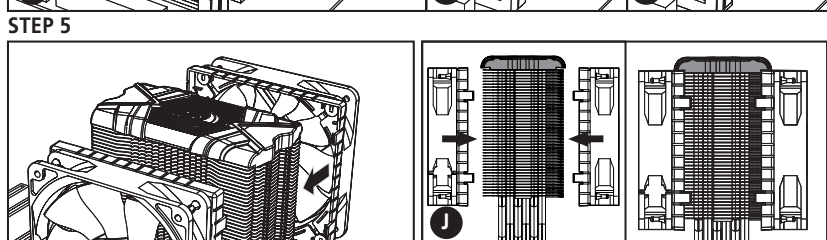
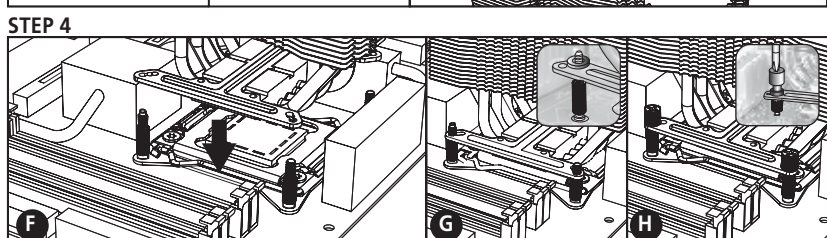
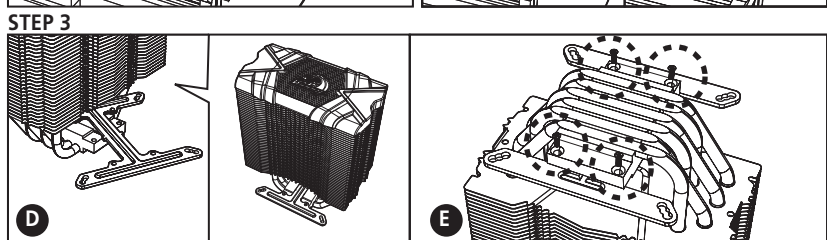
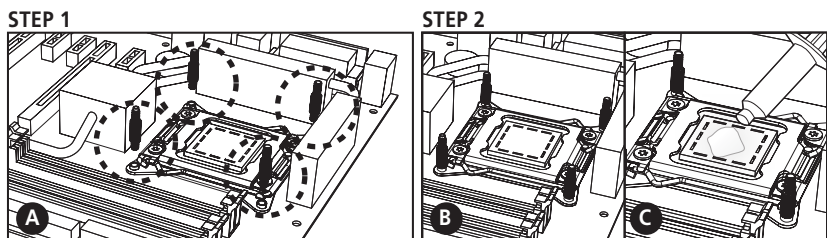

### Intel LGA775, 1155, 1156 and 1366

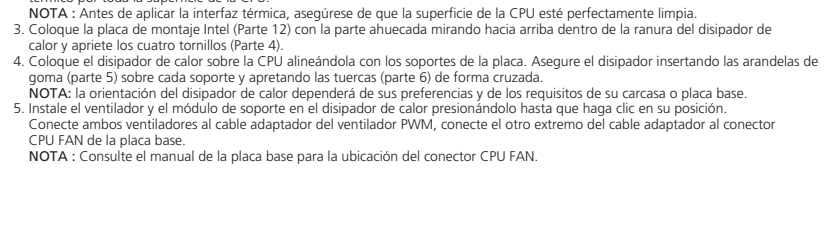
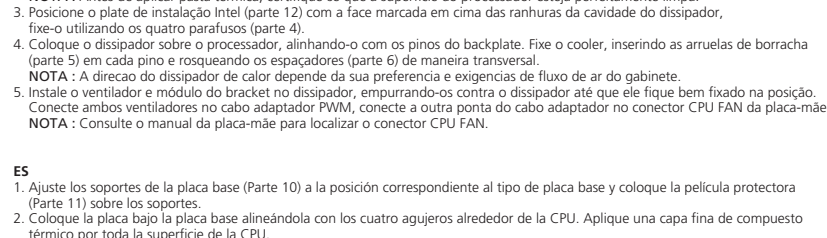
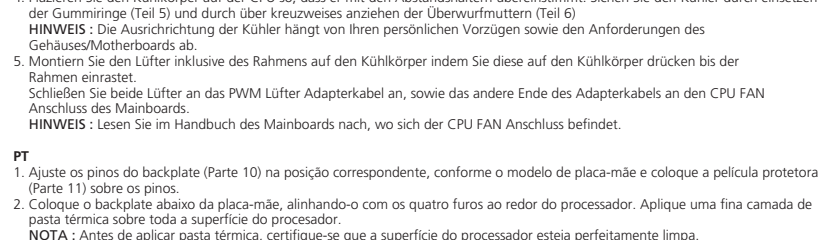
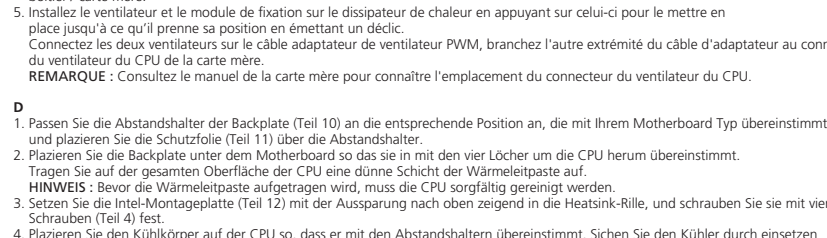
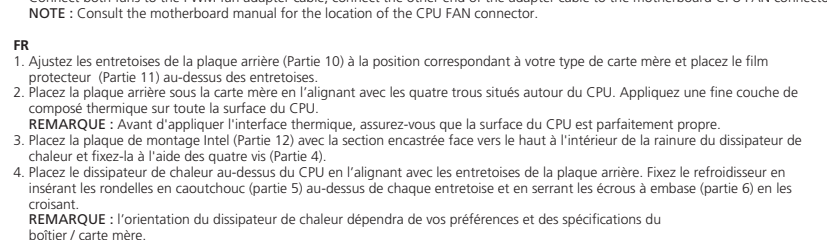
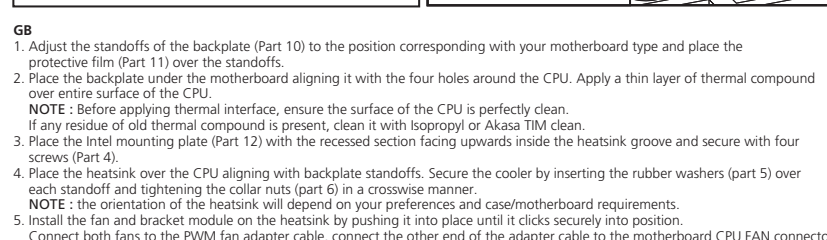
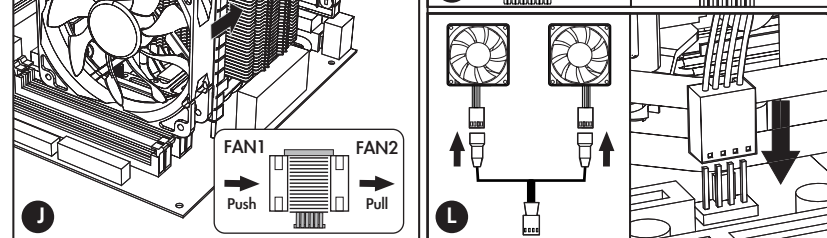
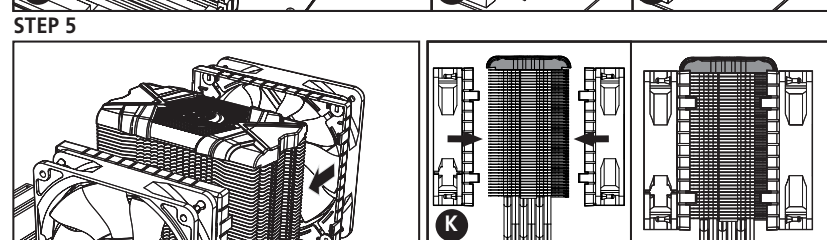
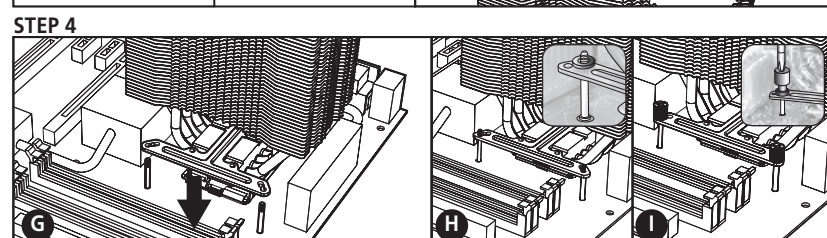
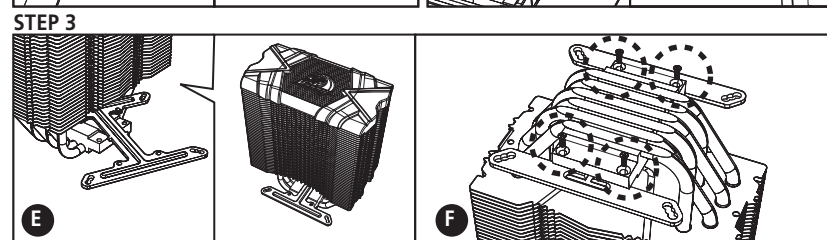
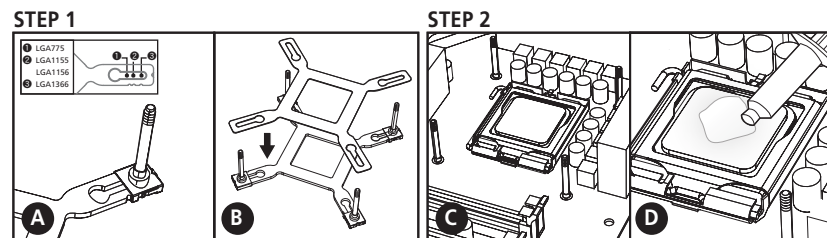

### AMD Socket AM2 / AM2+ / AM3

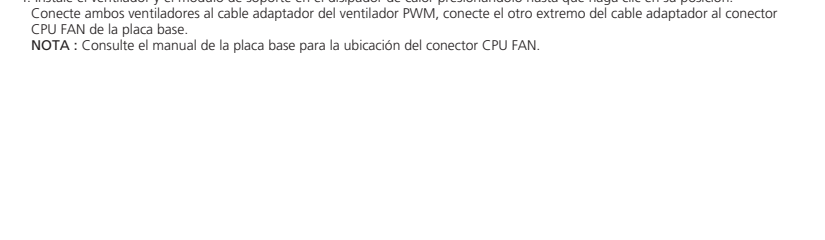
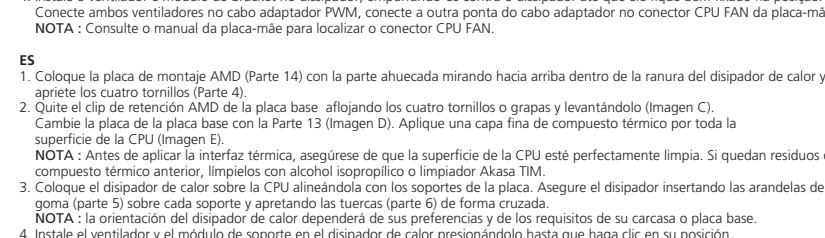
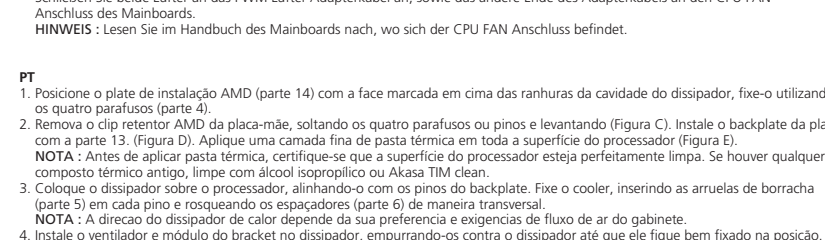
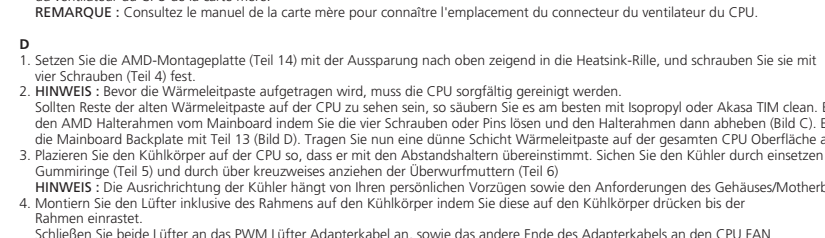
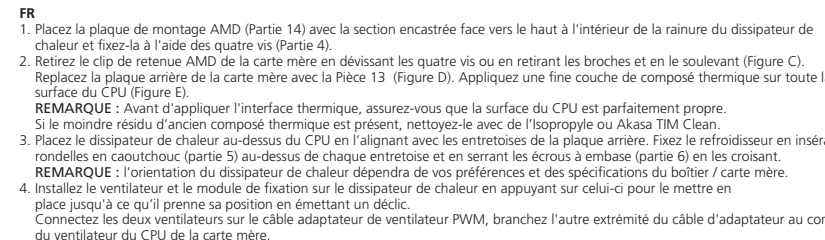
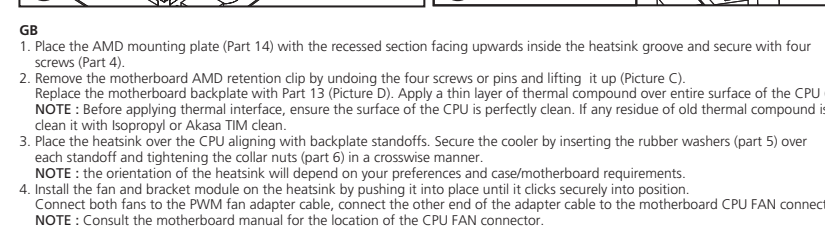
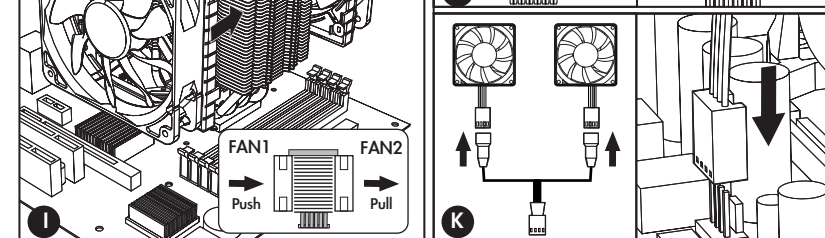
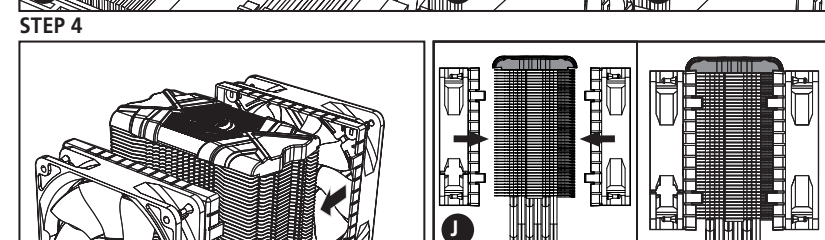
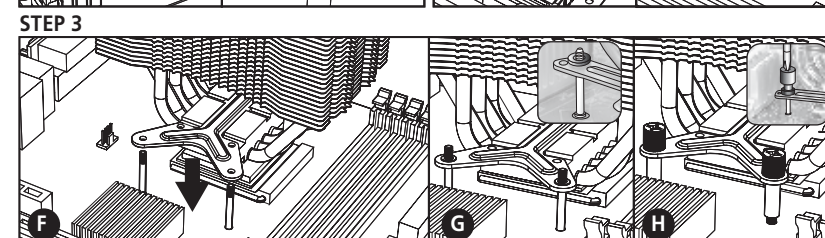
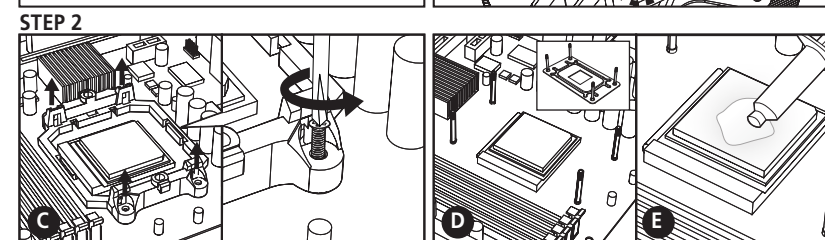
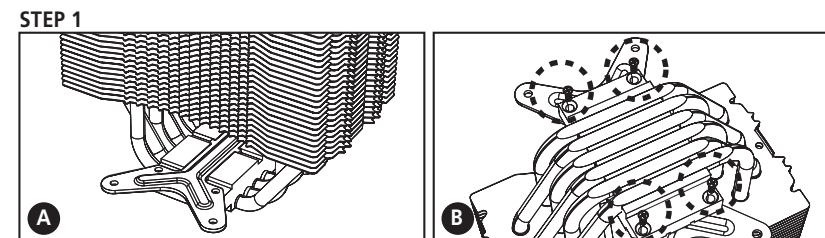

### Uninstallation instruction Intel and AMD

