

User's Manual

MODEL : ZM-WB5 Plus

CPU WATER BLOCK for Higher Water Cooling Performance



※ Please read this manual thoroughly prior to installation

<http://www.zalman.com>

Ver. 201204

1. Precautions

- 1) Test the product for leakage before installing it into the system. Once no leakage is confirmed, proceed with installation and usage.
- 2) Check the components list and condition of the product before installation. If any problem is found, contact the retailer to obtain a replacement.
- 3) Use coolant, approved for personal computer water cooling usage, mixed with distilled water to prevent corrosion.
- 4) Do not install the product if it interferes with any (motherboard) components.
- 5) To prevent leakage, this product is designed to prevent disassembly. Do not disassemble the product under any circumstance.

Zalman is not responsible for any damages caused by overclocking.

- 7) Excessive force exerted on the product may cause critical damage to the product and/or system.
- 8) The cooler must be removed when transporting the system. Zalman is not responsible for any damages that occur during transport of a system.

Product designs and specifications may be revised without prior notification to improve quality and performance.

- 10) Do not ingest Thermal Grease, and avoid its contact with skin and eyes. If contact is made with skin, wash off with water. If ingested or irritation persists, seek medical attention.

Disclaimer) Zalman Tech Co., Ltd. is not responsible for any damages due to external causes, including but not limited to, improper use, problems with electrical power, accident, neglect, alteration, repair, improper installation, or improper testing.

2. Specifications

Weight	154g	
Materials	Copper (base), Aluminum(case)	
Dimensions	53(W) x 63(L) x 40(H)	
Compatible CPU Socket	Intel	Socket 1155/1156/775
	AMD	Socket AM3 / AM2+ / AM2 / 754 / 939 / 940
Compatible Tubes (Outer x Inner)	Tube Clamp A	14x10mm, 13x10mm
	Tube Clamp B	13x9mm, 12x9mm, 12x8mm, 11x8mm, 10x8mm

3. Components

1) Common Components

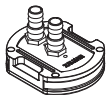

① One Cooler



② Tube Clamps A
(13.8x9.5mm)



③ Tube Clamps B
(11.5x8mm)



④ Thermal Grease



⑤ Paper Washer Sheet

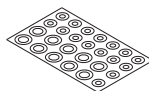

⑥ User's Manual

2) Intel Socket 1155/1156/775 Comports

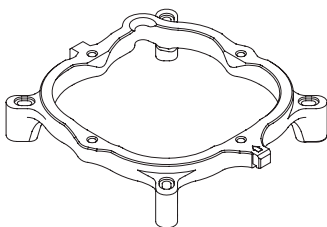

⑦ Intel Clip Support

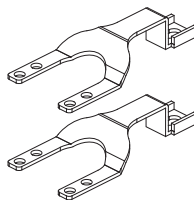

⑧ Intel Clip

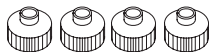

⑨ Nuts



⑩ Washers

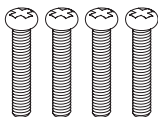

⑪ Bolts (Silver)

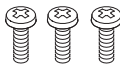

⑫ Bolts (Gold)

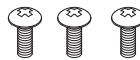

⑬ Bolts (Silver)

3) AMD Socket AM3/AM2+/AM2/754/939/940 Comports

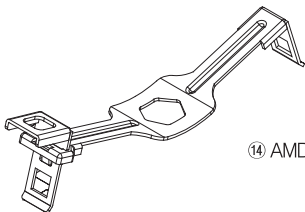

⑭ AMD Clip

4. Installation

1) Pre-Installation Verification

Make sure to install the cooler so that the outlet is placed above the inlet, as shown in the diagram.

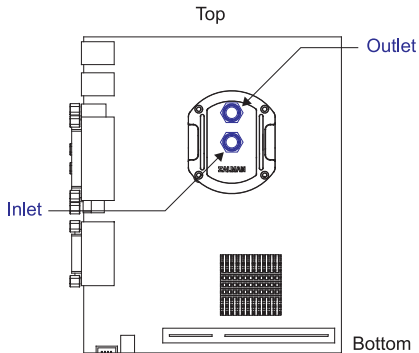

2) Installation don the Intel Socket 1155/1156/775

- ① Align the Intel Socket Clip Support with the motherboard installation holes and secure with Socket 1155/1156/775 Clip Support Fixing Bolts (Silver).

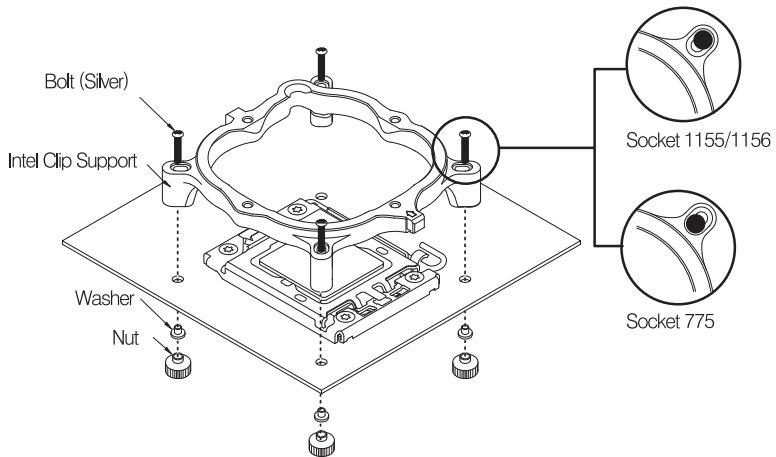

- ② Clear off any particles or residue from the CPU's surface then spread (outwards from center) a thin but thorough layer of Thermal Grease on the CPU and the base of the cooler.

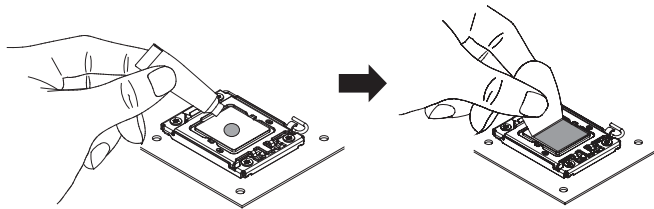

- ③ Secure the Intel Clip to the Cooler with the Intel Socket 1155/1156/775 Clip Fixing Bolts (Silver).

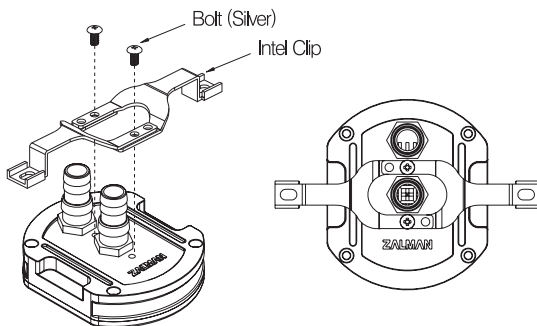

⚠ Caution

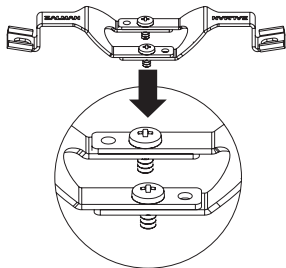

Please take extra care to align the attachment holes of the Two (2) Socket Intel Clips

- ④ Set the CPU Water Block at the center of CPU and secure the CPU Cooler with the Socket 1155/1156/775 Assembly Bolts (Gold) to the Clip Support.

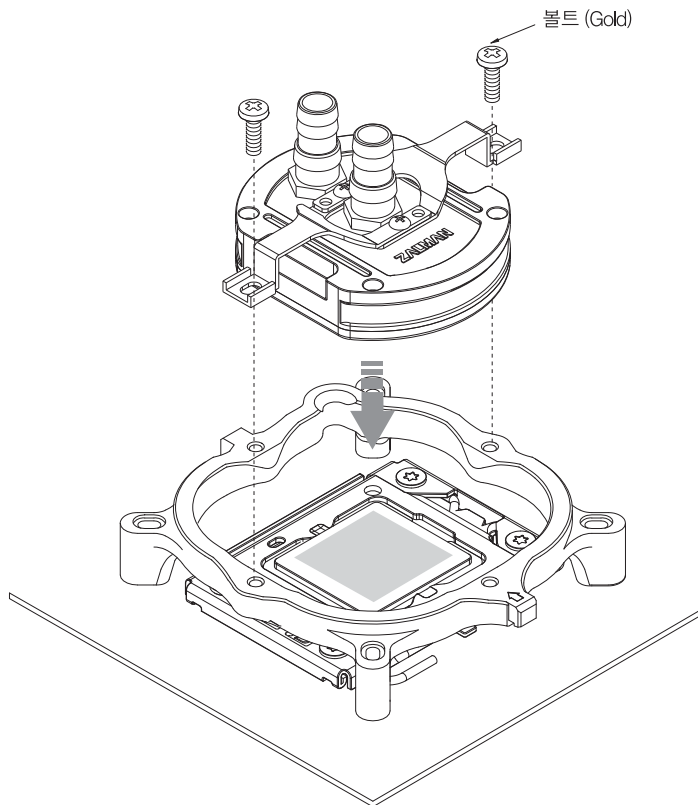

3) Installation on AMD Socket AM3 / AM2+ / AM2 / 754 / 939 / 94 0

Set the CPU Water Block at the center of the CPU and hook the flat side of the clip onto the motherboard clip support. Complete installation by exerting downward force on the levitated side of the Clip until both sides are hooked and fastened.

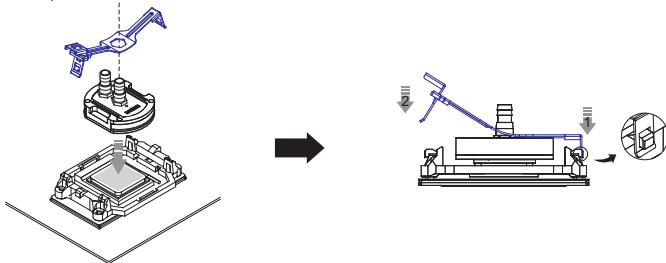

4) Tube Connection

Use a pair of wire pincers or pliers to unfasten the Tube Clamps, and insert the Tubes. Connect and fasten to the cooler as shown in the diagram.

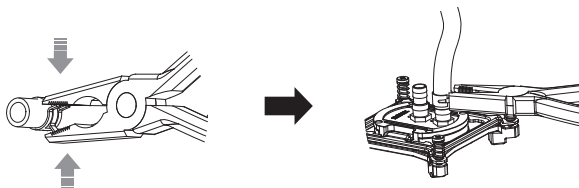

⚠ Caution

- ▶ Please refer to the Pre-Installation Verification on Page 3 to prevent the reversal of the Inlet and Outlet Tube Connections.
- ▶ Please make sure to use compatible Tube Clamps for the tube's diameter and adjust the insertion depth accordingly.

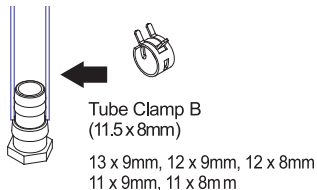
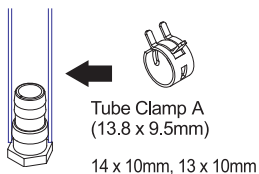

- ▶ Please test run the pump after installation to ensure proper operation.

User's Manual

MODEL : ZM-WB5 Plus

CPU WATER BLOCK for Higher Water Cooling Performance

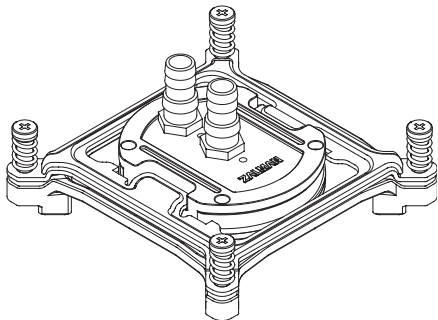

※ Please read this manual thoroughly prior to installation

<http://www.zalman.com>

Ver. 1.0

1. Precautions

- 1) Test the product for leakage before installing it into the system. Once no leakage is confirmed, proceed with installation and usage.
 - 2) Check the components list and condition of the product before installation. If any problem is found, contact the retailer to obtain a replacement.
 - 3) Use coolant, approved for personal computer water cooling usage, mixed with distilled water to prevent corrosion.
 - 4) Do not install the product if it interferes with any (motherboard) components.
 - 5) To prevent leakage, this product is designed to prevent disassembly. Do not disassemble the product under any circumstance.
Zalman is not responsible for any damages caused by overclocking.
 - 7) Excessive force exerted on the product may cause critical damage to the product and/or system.
 - 8) The cooler must be removed when transporting the system. Zalman is not responsible for any damages that occur during transport of a system.
- Product designs and specifications may be revised without prior notification to improve quality and performance.
- 10) Do not ingest Thermal Grease, and avoid its contact with skin and eyes. If contact is made with skin, wash off with water. If ingested or irritation persists, seek medical attention.

Disclaimer) Zalman Tech Co., Ltd. is not responsible for any damages due to external causes, including but not limited to, improper use, problems with electrical power, accident, neglect, alteration, repair, improper installation, or improper testing.

2. Specifications

Weight	154g	
Materials	Copper (base), Aluminum (case)	
Dimensions	53(W) x 63(L) x 40(H)	
Compatible CPU Socket	Intel	Socket 1366 / 775
	AMD	Socket AM3 / AM2+ / AM2 / 754 / 939 / 940
Compatible Tubes (Outer x Inner)	Tube Clamp A	14x10mm, 13x10mm
	Tube Clamp B	13x9mm, 12x9mm, 12x8mm, 11x8mm, 10x8mm

3. Components

1) Common Components



① One(1) Cooler



② Two(2) Tube Clamps A
(13.8x9.5mm)



③ Two(2) Tube Clamps B
(11.5x8mm)



④ One(1) Thermal Grease

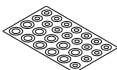

⑤ One(1) Paper Washer Sheet



⑥ One(1) User's Manual

2) Socket 1366 (Intel) Components



⑦ One(1) Socket 1366
Clip Support



⑧ One(1) Socket 1366 Clip



⑨ Four(4) Socket 1366 Clip
Support Fixing Bolts (Gold)



⑩ Four(4) Socket 1366
Washers

3) Socket 775 (Intel) Components

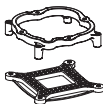

⑪ One(1) Clip support(top) One (1)
Backplate (bottom) for Socket 775



⑫ Two(2) Socket 775 Clip



⑬ Four(4) Socket 775 Clip
Support Fixing Bolts (Silver)



⑭ Three(3) Socket 775 Clip
Fixing Bolts (Silver)



⑮ Three(3) Socket 775 Clip
Assembly Bolts (Gold)

4) Socket AM3 / AM2+ / AM2 / 754 / 939 / 940 (AMD) Components



⑯ One(1) AMD Clip

4. Installation

1) Pre-Installation Verification

Make sure to install the cooler so that the outlet is placed above the inlet, as shown in the diagram.

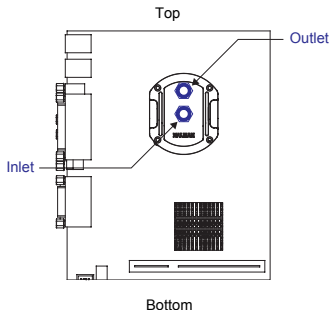

2-Ⓐ) Installation on Intel Socket 1366

- ① Align the Intel Socket 1366 Clip Support with the motherboard installation holes and secure with Socket 1366 Clip Support Fixing Bolts (Gold).

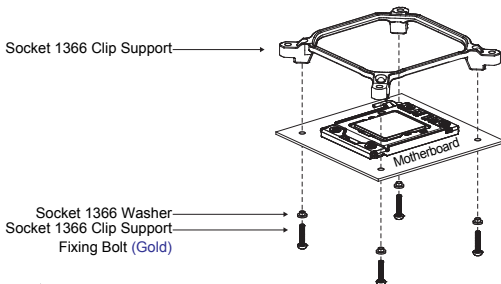

⚠ Caution

Socket 1366 Clip Support Fixing Bolts (Gold) must be used. Installation using the Socket 775 Clip Support Fixing Bolts (Silver) can cause damage to the Socket 1366 Clip Support.

- ② Clear off any particles or residue from the CPU's surface then spread (outwards from center) a thin but thorough layer of Thermal Grease on the CPU and the base of the cooler.

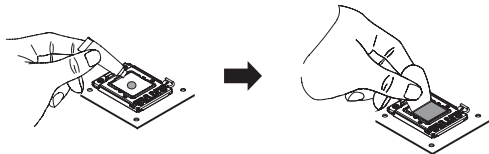

- ③ Cover the CPU with the cooler, and fix by tightening the bolts on the Clip onto the Clip Support.

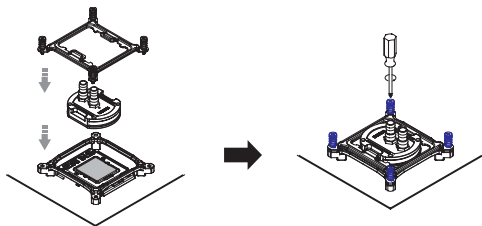

2-Ⓑ) Installation on Intel Socket 775

- ① Align the Socket 775 Clip Support (top) and Backplate (bottom) with the motherboard installation holes and secure with Socket 775 Clip Support Fixing Bolts (Silver).

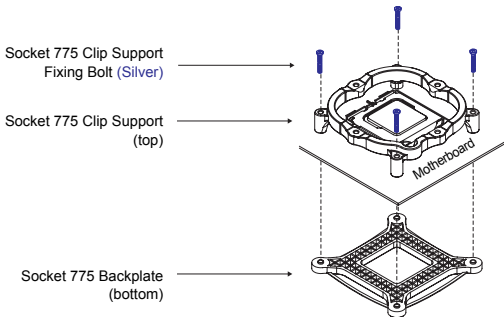

- ② Secure the Intel Socket 775 Clip to the Cooler with the Intel Socket 775 Clip Fixing Bolts (Silver).

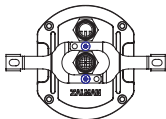
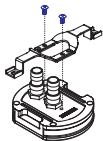

⚠ Caution

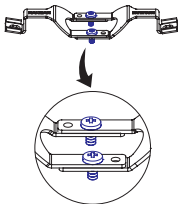

Please take extra care to align the attachment holes of the Two (2) Socket 775 Clips.

- ③ Clear off any particles or residue from the CPU'S surface then spread (outwards from center) a thin but thorough layer of Thermal Grease on the CPU and the base of the cooler.

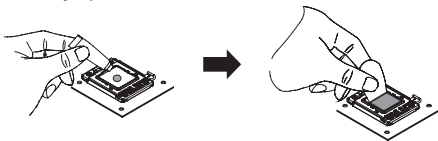

- ④ Set the CPU Water Block at the center of the CPU and secure the Cooler with the Socket 775 Assembly Bolts (Gold) to the Clip Support.

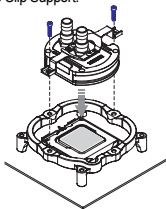

2-C) Installation on AMD Socket AM3 / AM2+ / AM2 / 754 / 939 / 940

Set the CPU Water Block at the center of the CPU and hook the flat side of the clip onto the motherboard clip support. Complete installation by exerting downward force on the levitated side of the Clip until both sides are hooked and fastened.

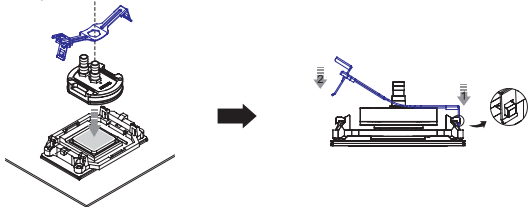

3) Tube Connection

Use a pair of wire pincers or pliers to unfasten the Tube Clamps, and insert the Tubes. Connect and fasten to the cooler as shown in the diagram.

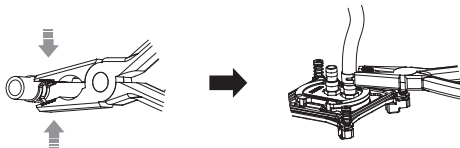

⚠ Caution

- ▶ Please refer to the Pre-Installation Verification on Page 3 to prevent the reversal of the Inlet and Outlet Tube Connections.
- ▶ Please make sure to use compatible Tube Clamps for the tube's diameter and adjust the insertion depth accordingly.

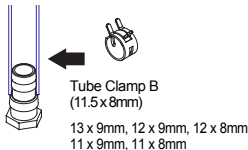
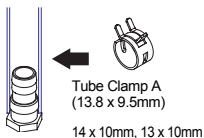

- ▶ Please test run the pump after installation to ensure proper operation.

Gaming PC Enclosures

GS1000 / GS1000SE

- E-ATX / Standard ATX / microATX Compatible
 - * Supports Intel Dual Xeon server motherboards
- UP to 6 Hot Swap HDD Bays
 - * GS1000(3 Standard / 3 Optional) / GS1000 SE(Optional)
- Tool-Free HDD Installation
- Airflow Optimized Design
- Vibration Absorbing HDD Dampers and Feet
- The World's First Roller Rails for smooth & Easy PSU Installation
- Cable Compartment Behind the Motherboard for Cable Management
- Dedicated Fan Compartment for Fanless PSU Users
- Up to a Total of 8 HDD Bays
 - * 2 Adaptors & Bezels included for use of two 5.25" bays as 3.5" Internal (HDD) / External (FDD) Bays



GT1000

- High-End Gaming Enclosure Built with Sturdy All Aluminum Panels
- Three Tool-Free Hinged Magnetic Panels (2 Left, 1 Right) for Easy Installation and Access to Components
- Tool-Free Installation of Disk Drives, Fan Controls, Audio Interfaces etc.
- Accommodates up to 6 Hard Drives
- Luxurious and Cool Aesthetics.
- Color Option: Black (Red LED Fans), Titanium (Blue LED Panel)



For more information, please visit our website.