

Installation Guide

NEWSTAR
computerproducts

www.newstar.eu

UNIVERSAL BEAMER CEILING MOUNT

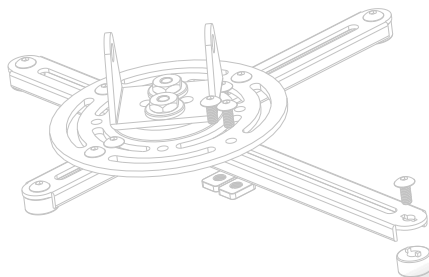
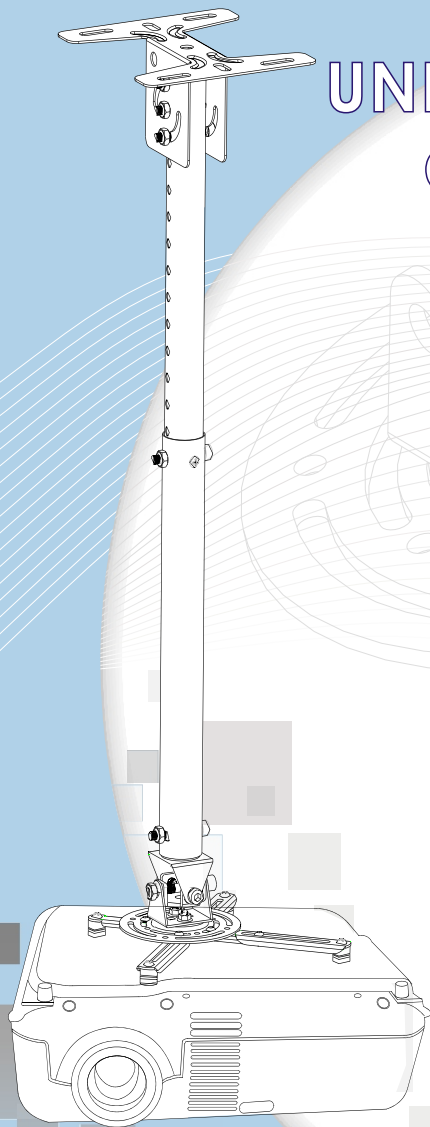

Model:
BEAMER-C100
BEAMER-C100SILVER

- Thank you for purchasing the Ultimate Universal Projector Ceiling Mount. This bracket is suitable for about most of projectors up to a load for 15kg (33)lbs
- To ensure correct usage, please read this instruction manual thoroughly. Keep this manual for future reference.
- Brackets should be mounted only by a qualified installer.
- User will be responsible for any injuries and damages that may arise from improper installation and handling of Universal Ceiling Mounting Kit.
- Ensure all mounting screws are appropriately positioned and properly tightened/fastened.
- Installers are to ensure customer's safety during installation.
- We reserve the right to amend or undertake any necessary changes without prior notice.



WARNING

This symbol indicates the incorrect handling. Ignoring this symbol can result in the possibility of personal injury or even death.



CAUTION

This symbol indicates the incorrect handling. Ignoring this symbol can result in the possibility of personal injury and physical damage.



This symbol indicates additional cautions (including warnings).



This symbol indicates forbidden actions.



This symbol indicates required actions.



Caution
(general)



Forbidden
(general)



Required
(general)

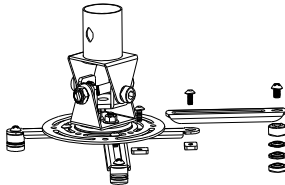
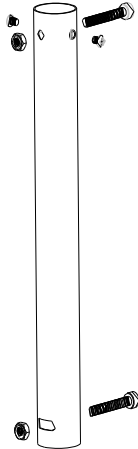
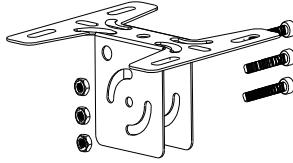

- Assembling without the use of bolts and screws at designated points may result in injury and damage to properties or the unit collapsing from its installed position. Should a malfunction occur disconnect the power from the main socket and surround the area with ropes to prevent others from getting near it.
- Check and ensure the ceiling where you install can support the load of the unit and Ceiling Mounting.
- All Ceiling Mounting Brackets are to be firmly secured so the unit will not drop off its installed position.

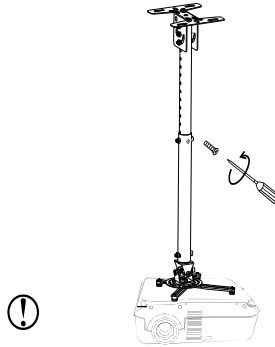

- Steps should be taken to ensure the ceiling and installed unit can withstand external forces like earthquakes, vibrations, etc.

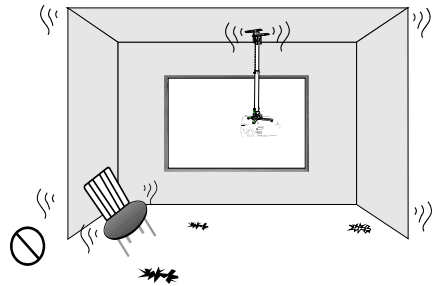

- Do not remove any bolts and screws from the Ceiling Mounting Brackets or do any changes to the Ceiling Mounting Brackets.

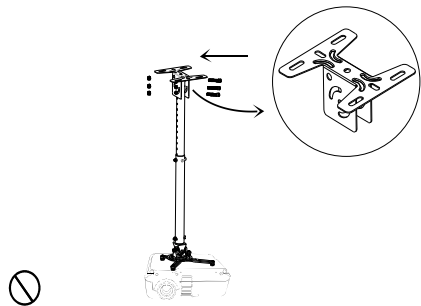

- Do not install near an air-conditioner.

Do not install at place where there are excessive dust and smoke as fire could arise from these sources.

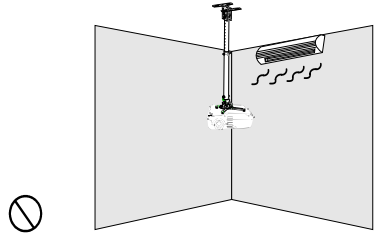

- Keep the room well ventilated to prevent room temperature rising and possibilities resulting in fire.

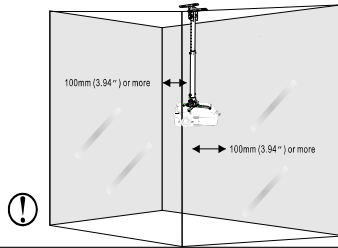

- Do not install in location where room temperature and humidity are excessively high to prevent fire.

- To prevent fire, avoid contact with water.

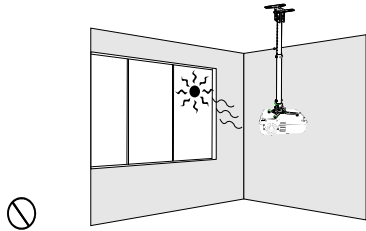

- Do not apply unnecessary stress or load on the installed unit.

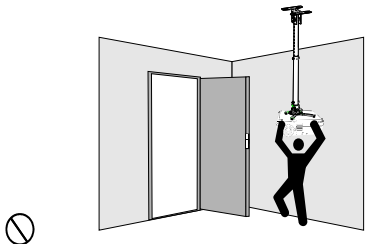

1. Each package should contain the parts listed and shown below

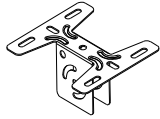

Ceiling Mounting plate..... 1pc

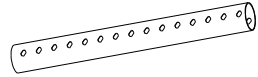

Upper Rod..... 1pc



Lower Rod..... 1pc

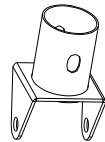

Lower connector..... 1pc

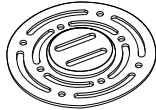

Universal Base plate..... 1pc

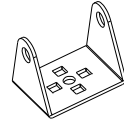

U-Shape Joint Bracket..... 1pc

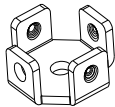

Hexagon connector..... 1pc



Long Extension Bracket 1
100mm..... 4pcs

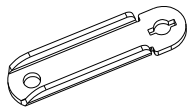

Short Extension Bracket 1
50mm..... 4pcs

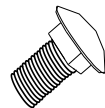

M6x12 Carriage Bolt..... 2pcs

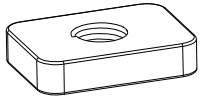

Square nut.....8pcs

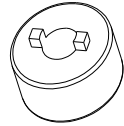

Bottom Spacer.....4pcs

Truss Head Screw



M4X15/M4X20/M4X254pcs
M5X15/M5X20/M5X254pcs
M6X15/M6X20/M6X254pcs
M6X5.....2pcs

Socket Cap Screw

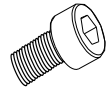

M8X15.....2pcs
M8X55.....5pcs
M8x65.....1pc



M8 Spring Washer.....4pcs



M8 Self-Locking Nylon Nut.....5pcs

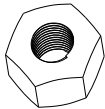

M8 hexagon Nuts.....1pc

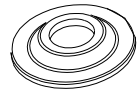

Washer 1mm.....4pcs
Washer 2mm.....4pcs
Washer 4mm.....4pcs

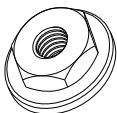

M6 Serrate Flange Nut.....2pcs

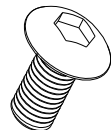

M5X10
Socket Button Cap Screw.....8pcs

1. Assembly Procedure-Installation of Suspension Rod

1.1

Install upper rod
Install the upper rod using M8x55 Socket Cap Screw and M8 Self-Locking Nylon Nut, Ceiling Mounting Plate

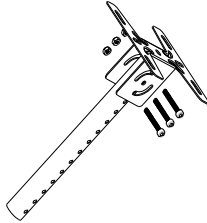

1.2

Install lower rod
First align two holes on the lower rod at the suitable holes on the upper rod, tighten them with M8x55 Socket Cap Screw and M8 Self-Locking Nylon Nut.

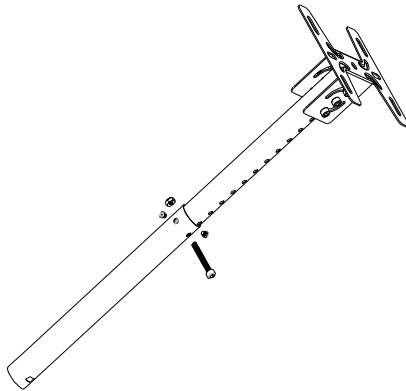

1. 3

Install the preassembled universal base plate.
Fixed the Lower connector (Preassembled with universal base plate) together with M8x55 socket cap screw and M8 self-locking Nylon Nut refer to drawing.

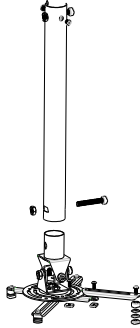

2. Parts Assembly - Installation of Universal Base

2.1

Lift the Projector with both middle finger along the depth of the Projector to search for the Central Gravity (CG).

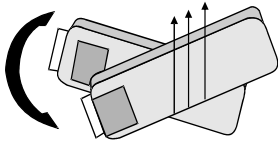

2.2

Lift the Projector with both middle finger along the depth of the Projector to search for the Central Gravity (CG).

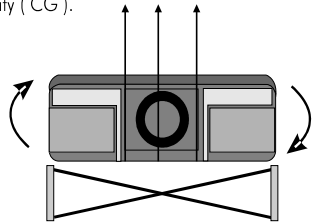

2.3

When the CG Point (Depth of Projector) and (Width of projector) intersection meet , that will be the assume CG of Projector.

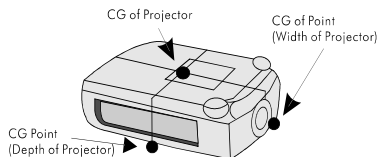

2.4

Locate the Projector CG Position and determine screw size for mounting the Projector. Place the Universal Base Plate near to the Projector CG and select the suitable Extension Bracket given in the package.

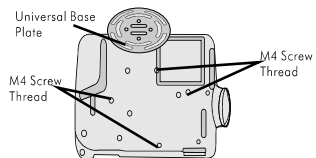

2.5

Select the suitable Extension Bracket from the Package. There are 2 size available as shown. There are also 3 types of combination.

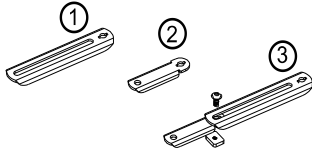

2.6

Select the suitable Extension Bracket and place it on the Projector near the CG position follow by the Universal Base Plate. Make sure the Extension Bracket is able to assemble to the Universal Base Plate.

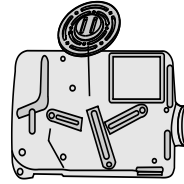

2.7

Assemble the selected Extension Bracket with the following items: Bottom Spacer, Spacer (if needed) & Square Nut.

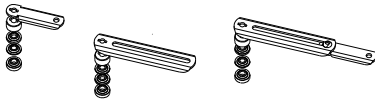

2.8

Assemble the respective Extension Bracket to the Projector as shown in the picture. Using respective Truss Head Screw from the given package to tighten lightly.

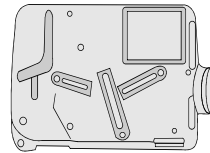

2.9a

Assemble the Universal Base Plate with the required items as shown in the picture.

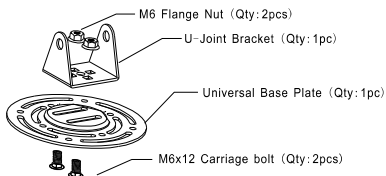

2.9b

Full assembled of the Universal Base Plate as shown in the picture.

*Do not tighten the M6 Nut until the CG is finalized.

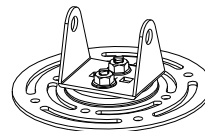

2.10

Align the assembled Universal Base Plate with all the Extension Bracket as shown in the picture. Using M5 Button Socket Cap Screws to hand tighten it.

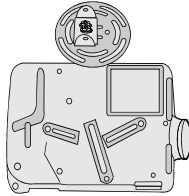

2.11

Connect the cross connector to the u-shape joint bracket using M8X65 socket cap screw and M8 Hexagan Nut with Ø8 spring washer. Next connect the lower connector to the rest of the parts using M8X15 socket cap screw with Ø8 spring washer. The assembly is then complete.

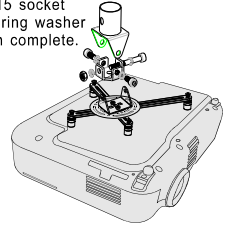

2.12

For easy and quick installation the Universal Base has been preassembled.

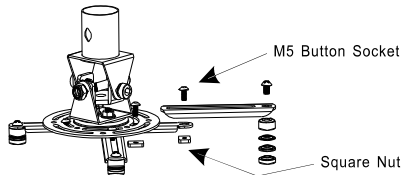

3. Installation of Universal Ceiling Mounting Kit

3.1

Install the Universal Ceiling Mounting Kit to the ceiling. Fix Suspension Rod by M10 expansion bolt(not included) on the ceiling. Refer to drawing.

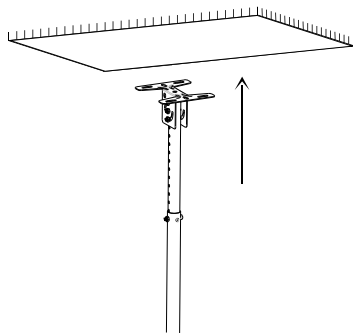

3.2

Install the Universal Base Plate with the projector (B) using M8X55 Socket Cap Screw and M8 Self-locking Nylon Nut, to joint A and B together.

Put screw into cross adapter by this hole.

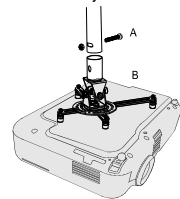

3.3

Installation completed.

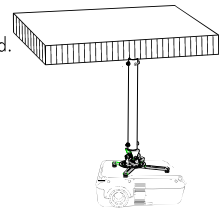

***Please consult our authorized service person when you meet any trouble in installation. We are not liable for any damage or injury caused by mishandling or improper operation.**

Installation Guide

NEWSTAR
computer products

www.newstar.eu

UNIVERSAL BEAMER CEILING MOUNT

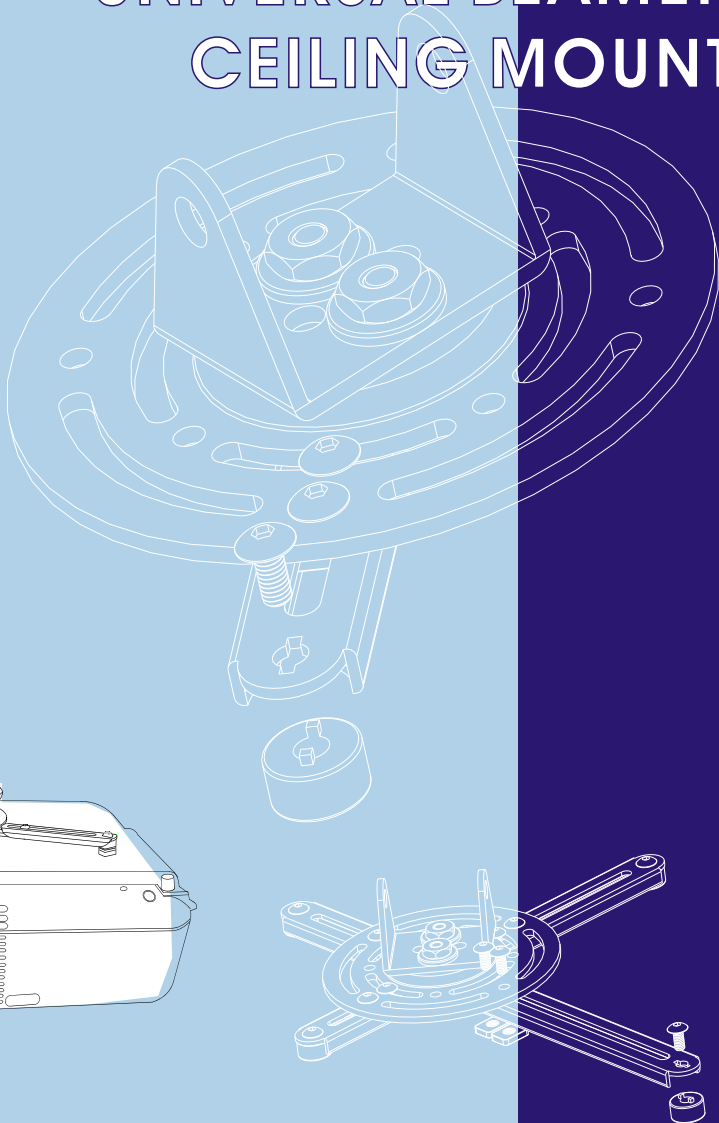
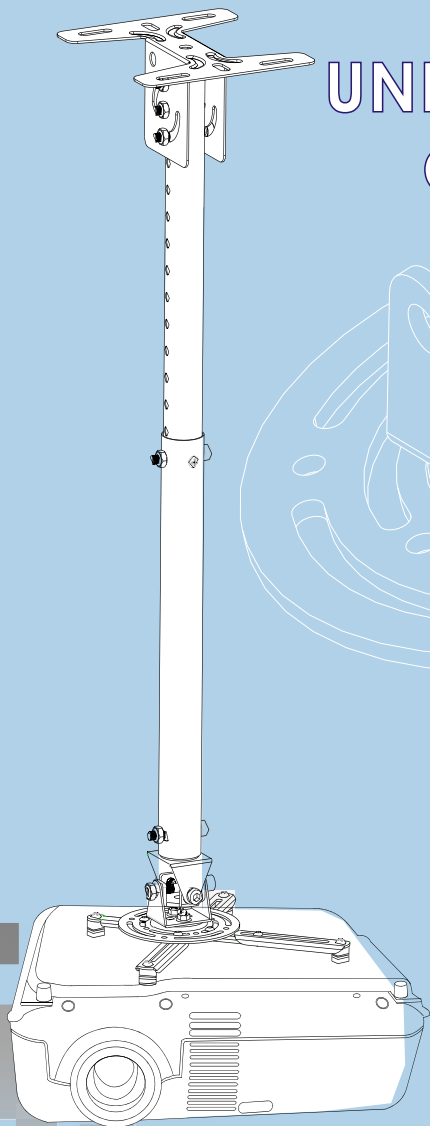

CFB

All Rights Reserved
Unauthorized Copying and Reproduction are prohibited