

AMR2AP

Articulating Dual Monitor Mount (Grommet Base)

The AMR2AP is a dual interactive LCD arm stand that provides users comfortable viewing angles. It has an aluminum structure with an easy cable management design. The simple grommet base feature allows for a less cluttered and larger workspace.



Specifications

• **General**

Max Hole Pitch:	• 100x100/75x75mm	Screw Type:	• M4
Material:	• Steel/Aluminum/Alloy/Plastic	Dimensions (W*H*D):	• 1150 x 543 x 150mm 45.28" x 21.38" x 5.9"
Weight:	• 4.1kg (9.04 lbs)	Swivel:	• Max. +/-90°
Tilt:	• Max. +90° / -20° (Hinge) • Max. +65° / -30° (Arm)	Rotate(Pivot):	• 360°
Support Max Weight:	• 2-10kg (4.4-22.1lbs)	Support Flat Panel Size:	• <= 24"
Extended Arm Provided:	• 4	Height Adjustment Range:	• 315mm (12.4") (Hinge)
Min.Distance to the Wall	• 97mm (3.82")		

• **Warranty and Support**

Warranty: 3 Years
Support: Free technical support (phone/email)

AMR2AP

Articulating Dual Monitor Mount (Grommet Base)

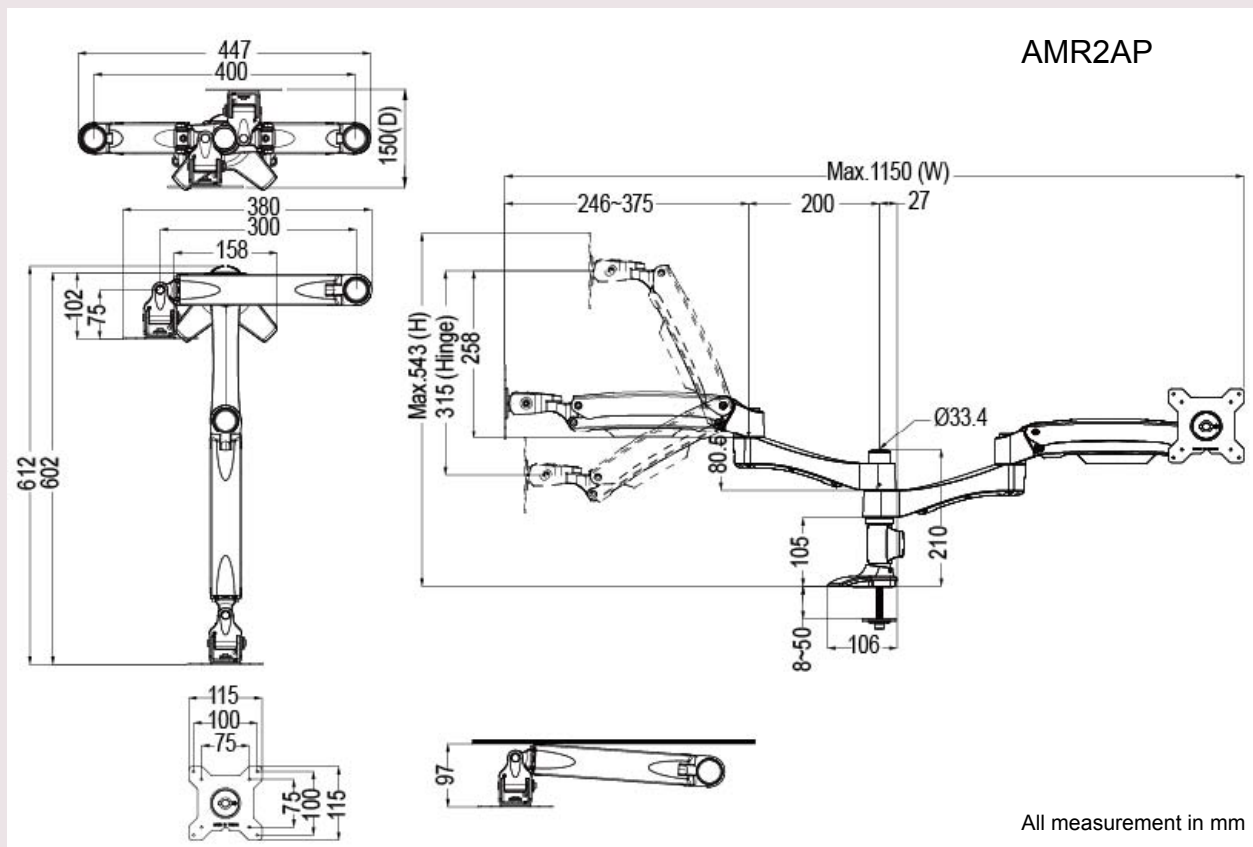

www.amer.com / www.amermounts.com

sales@amer.com

1-800-262-9703

Specifications subject to change without notice. Errors and omissions excepted. All trademarks are properties of their respective owners.

Revision 2.01