

AMR2AC

Articulating Dual Monitor Mount

The AMR2AC is a dual interactive LCD arm stand that provides users comfortable viewing angles. It has an aluminum structure with an easy cable management design. The simple clamp feature allows for a less cluttered and larger workspace.



Specifications

General

Max Hole Pitch:	• 100x100/75x75mm
Material:	• Steel/Aluminum/Alloy/Plastic
Weight:	• 6.9kg (15.21 lbs)
Tilt:	• Max. +90° / -20°
Support Max Weight:	• 10kg (22.04lbs)
Compliant with VESA:	• 100x100 & 75x75mm mount

Screw Type:	• M4
Dimensions:	• (W*H*D) 1000*497*619 mm
Swivel:	• Max. +/-90°
Rotate(Pivot):	• 360°
Support Flat Panel Size:	• 15" - 24"

Warranty and Support

Warranty:	3 Years
Support:	Free technical support (phone/email)

AMR2AC

Articulating Dual Monitor Mount

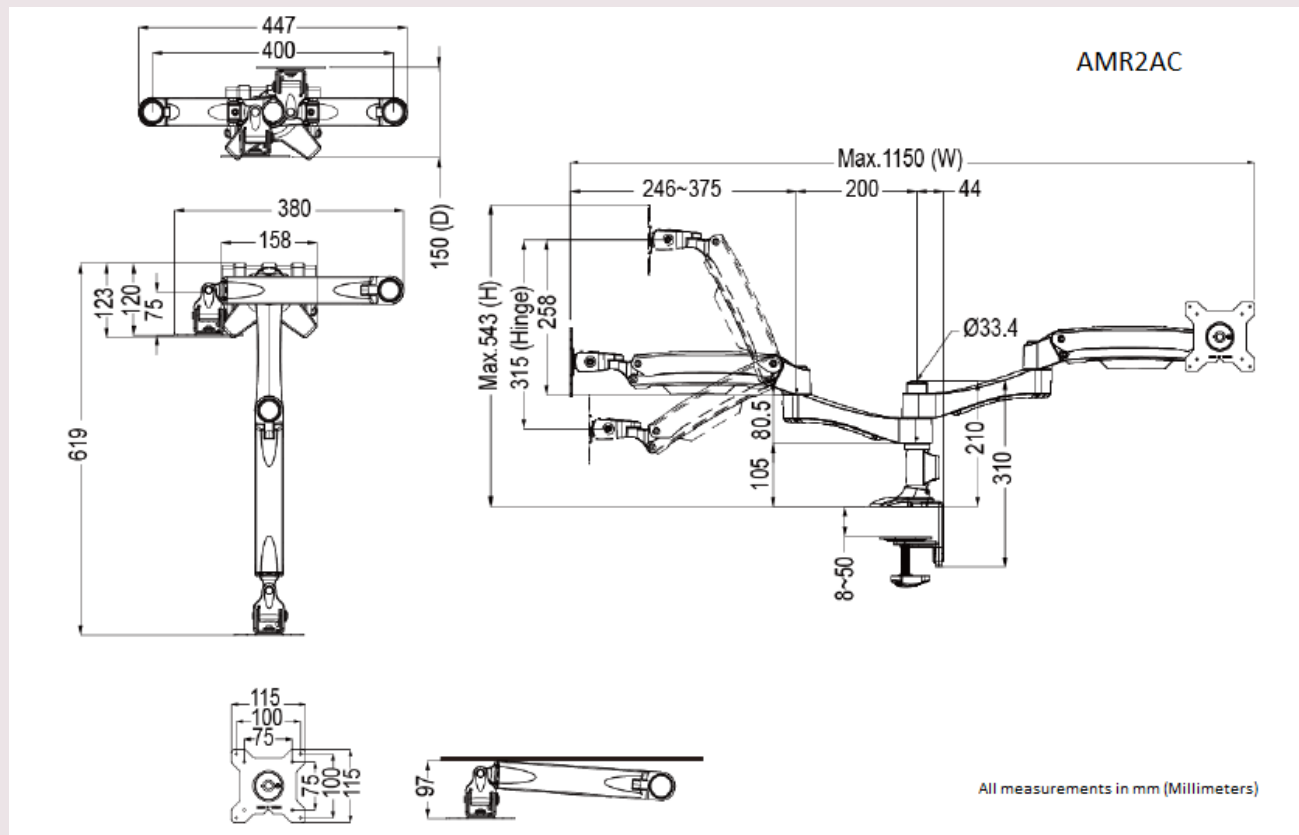

www.amer.com / www.amermounts.com

sales@amer.com

1-800-262-9703

Specifications subject to change without notice. Errors and omissions excepted. All trademarks are properties of their respective owners.

Revision 2.02